

Sailing catamaran Leopard 48

BASIC INFORMATIONS	LAYOUT
<ul style="list-style-type: none"> ▪ Year: 2016, 2017 ▪ Length: 14.75 m ▪ Beam: 7.64 m ▪ Draft: 1.31 m ▪ Displacement: 17,000 kg ▪ Engines: 2 x 54 HP ▪ Fuel tank: 700 L ▪ Water tank: 1000 L ▪ Double cabins: 4 ▪ Single cabins: 2 ▪ Bed in saloon: convertible table ▪ Persons [recomm./licensed]: 8 / 10 ▪ Showers [cabins + forepeak + DECK]: 4 + 1 + 1 ▪ Heads [cabins + forepeak]: 4 + 1 	 <p>single cabin deck and cabin access</p> <p>single cabin deck access, WC and shower</p>
<p>HIGHLIGHTS</p> <ul style="list-style-type: none"> ▪ Air-conditioning System - Cruisair (in saloon and cabins) ▪ Genset – for Leopard 48 (2016) Fisher Panda 8 kW, for Leopard 48 (2017) Norther Lights 9kW ▪ Inverter/Battery Charger: 12V - 220V 2.7kW ▪ Watermaker (12V), 60L/h with controller ▪ 220V Shore Power Pack ▪ Custom stainless steel davit system with tackle c/w electric winch ▪ Electric Sheet winch - Lewmar 55EST ▪ Fusion 700i Series Marine Stereo in saloon with docking station ▪ External speakers in forward cockpit: 2 x speakers with wired remote and amplifier 	<p>HIGHLIGHTS - continued</p> <ul style="list-style-type: none"> ▪ 2x Solar panels 70W each fitted to hard top ▪ Leopard 48 2016 - Electric flushing toilets: 2 Jabsco quiet flush (seawater option; aft cabins) & 2 standard manual toilets (fwd cabins) ▪ Leopard 48 2017 - Electric flushing toilets: 4 Jabsco quiet flush (seawater option) ▪ Combination mixer shower faucet in galley ▪ Cockpit 12V Refrigerator ▪ Teak deck ▪ Stern shower: hot/cold water ▪ Dinghy with outboard engine 9,9 HP ▪ Ventilation fans in cabins and saloon ▪ Double USB socket in cabins (x4)
<p>SALOON</p> <ul style="list-style-type: none"> ▪ Saloon table convertible to a coffee table or to standard double bed, c/w mattress ▪ 2x Ventilation fans in saloon ▪ Air-conditioning System - Cruisair (in saloon and cabins) ▪ Provision for TV/DVD in saloon - swing bracket and AC outlet ▪ Laminate finishes with solid wood trims ▪ Settee - U-shape ▪ Wear resistant simulated wood flooring ▪ LED overhead lighting ▪ Ample ventilation through fwd facing portlights ▪ Stowage space under settee cushions ▪ 2 x Escape hatches under stairways to hulls ▪ Front doorway access to forward cockpit 	<p>HEADS COMPARTMENTS x 4 (4 CABIN VERSION)</p> <ul style="list-style-type: none"> ▪ Leopard 48 2016 - Electric flushing toilets: 2 Jabsco quiet flush (seawater option; aft cabins) & 2 standard manual toilets (fwd cabins) ▪ Leopard 48 2017 - Electric flushing toilets: 4 Jabsco quiet flush (seawater option) ▪ Washbasins with basin mixer and Corian top ▪ Vanity locker with mirror ▪ Towel hook, rail and ring ▪ Separate shower compartment with acrylic door c/w lever mixer and adjustable shower rose ▪ Shower sump with push-button drainage ▪ LED Overhead lighting ▪ Overhead roller blinds for privacy ▪ Large bowl toilet
<p>GALLEY</p> <ul style="list-style-type: none"> ▪ Combination mixer shower faucet in galley ▪ Galley full equipped - plates, cups, saucers, glasses, flatware for twelve; pots, pans, miscellaneous food prep; cooking & serving utensils; kettle, microwave, blender, coffee maker, ice maker, citrus press ▪ Corian galley worktop surfaces ▪ Single lever mixer faucet ▪ Double s/s sink ▪ Dish and cutlery drying recess with drainage ▪ Vitrefrigo 2-drawer front-opening fridge/freezer 56USgal / 212Ltr 12v refrigeration ▪ ENO gas 3-burner hob ▪ Gas solenoid shut-off valve with control at switch panel & warning light at cooker ▪ Gas cylinder regulator in dedicated cockpit LPG locker ▪ Separate garbage bin locker with side & top access ▪ Stowage space in shelf lockers ▪ Corian galley shelf with spice rack ▪ 4 x Galley drawers ▪ 1 x Pot storage drawer below oven ▪ 1 x Large overhead storage drawer 	<p>ENGINE & CONTROLS</p> <ul style="list-style-type: none"> ▪ 2 x Yanmar 4JH5CE 54 HP engines with sail drives ▪ Double lever throttle / gearshift control ▪ Sound deadening panels in engine room ▪ 2 x Engine room ventilation fans and ducting ▪ 2 x Propellers - 3-blade fixed ▪ 2 x Fuel deck fillers ▪ 2 x Fuel filter / water separators ▪ 2 x Fuel tanks aluminum 185USgal / 700Ltr total capacity ▪ 2 x Exhaust skin fittings (s/s) ▪ 2 x Exhaust water locks ▪ 2 x Cooling water inlet strainers ▪ 2 x Exhaust cooling water temperature sensors with audible alarms at helm
<p>NAVIGATION CONSOLE</p>	<p>NAVIGATION EQUIPMENT</p>

Sailing catamaran Leopard 48

<ul style="list-style-type: none"> ▪ Chart table surface with overhead LED light ▪ Instrument and switch panel ▪ Chart table bench seat c/w stowage under cushion 	<ul style="list-style-type: none"> ▪ Raymarine Base Pack: includes Ray55 VHF at navstation (EUROPE - Rest of the World), p70 color autopilot display, log & depth instrument with retract, depth & speed transducers ▪ Raymarine Color Upgrade: 2x i70 color instrument displays (instead of i60 wind instrument and i50 Tridata) ▪ Raymic 2nd station VHF at helm for Ray55 ▪ e95 Hybridtouch multifunction display with WiFi at helmstation ▪ HD Colour Radar includes 4 kW 18" 48nm Radome scanner ▪ Raymarine Automatic identification System AIS 650 Transceiver ▪ AIS, autopilot, EPIRB, GPS, Radar, speed log, VHF, wind instruments ▪ Compass at helm position
<p>CABINS x 4 (4 CABIN VERSION)</p> <ul style="list-style-type: none"> ▪ 4x Full length mirrors behind cabin doors ▪ 4x Ventilation fans in cabins ▪ Double USB socket in cabins (x4) ▪ Air-conditioning System - Cruisair (in saloon and cabins) ▪ Laminate finishes with solid wood trims ▪ Double berths: <ul style="list-style-type: none"> - Fwd Bunks (56in / 1.42m x 80in / 2.05m) - Aft Bunks (59in / 1.50m x 80in / 2.05m) ▪ 2 x Engine room ventilation fans and ducting ▪ Hanging locker with lower shelf ▪ Bedside cave locker/table ▪ LED lighting - overhead reading lamps ▪ Overhead roller blinds for privacy ▪ Large open shelves ▪ Stowage drawers under bunk ▪ Large hull window incorporating portlight and pleated blind 	<p>RUDDER & STEERING SYSTEM</p> <ul style="list-style-type: none"> ▪ Leather covered steering wheel ▪ Balanced spade rudders ▪ Rudder stock in F16ph stainless steel ▪ JP3 Self aligning bearings ▪ Chain and wire steering system c/w bulkhead steering unit and brake ▪ Emergency tiller (s/s)
<p>FOREPEAK – single cabins</p> <ul style="list-style-type: none"> ▪ Forepeak berth and heads starboard including light, fan, PAR Brydon large bowl manual toilet, hand basin complete with combination faucet/shower mixer; right peak access from deck only ▪ Forepeak berth port including light and fan with access from the deck and forward cabin 	<p>ELECTRICAL INSTALLATION</p> <ul style="list-style-type: none"> ▪ Fusion 700i Series Marine Stereo in saloon with docking station. Includes Bluetooth, USB & AUX connectivity. Fusion Marine speakers in saloon (2) & aft cockpit (2). Wired remote control at helm station (1). - Note: Raymarine MDFs & personal wireless devices (only if connected wirelessly to Raymarine MDF via the Raymarine APP) can control system ▪ External speakers in forward cockpit: 2 x speakers with wired remote and amplifier ▪ 220V Shore Power Pack: includes 2x heavy duty 50 ft 30 amp shore powerlines, AC switch panel, HWC 220V conversion, AC outlets in cabins, galley, at freezer and switch panel ▪ Inverter/Battery Charger: 12V - 220V 2.7kW inverter with 125A charge rate, including remote operation panel with battery monitor ▪ Upgrade standard Lead Acid house and engine batteries to AGM batteries ▪ Two additional AGM house batteries (210 Ah) ▪ Ventilation fans in saloon (x2) and cabins (x4) ▪ Double USB socket in cabins - for 4 cabin layout ▪ Genset – for Leopard 48 (2016) Fisher Panda 8 kW, for Leopard 48 (2017) Norther Lights 9kW ▪ Air-conditioning System - Cruisair: 40,000 BTU Total [(2) 12,000 BT and (1) 16,000 BTU] 220v [saloon and cabins] ▪ Electric Sheet winch - Lewmar 55EST - 1 off ▪ Provision for TV/DVD in saloon - swing bracket and AC outlet ▪ 2x Solar panels 70W each fitted to hard top ▪ Watermaker (12V), 60L/h with controller ▪ Custom stainless steel davit system with tackle c/w electric winch ▪ LED Courtesy lights at stairways ▪ LED Bi-colour & stern navlights ▪ 12v DC switch panel ▪ 2 x 12v outlet sockets at switch panel and at helm station ▪ 2 x Fuel tank gauges at helm position ▪ 2 x Ammeters at helm position ▪ 2 x House batteries - 210Ah deep cycle lead acid type ▪ 2 x Engine starter batteries - 100Ah lead acid type ▪ 1 x House battery isolator switch ▪ 2 x Engine starter battery isolator switches ▪ 2 x Alternators, standard with engines

Sailing catamaran Leopard 48

	<ul style="list-style-type: none"> ▪ 1 x Electrical spares kit: fuses, relays, fuse holders ▪ 1 x Electric fog horn with control at helm station
DECK FITTINGS	DECK FITTINGS - continued
<ul style="list-style-type: none"> ▪ 2x Solar panels 70W each fitted to hard top ▪ Deck wash fitting - dual fresh/salt water system ▪ Stern shower: hot/cold water ▪ LPG gas outlet on stern rail for optional BBQ ▪ Cockpit 12V Refrigerator ▪ Removable helm seat spray dodger ▪ Aft cockpit side & back shade curtains only ▪ Aft cockpit cushions ▪ Forward cockpit cushions ▪ Custom stainless steel davit system with tackle c/w electric winch ▪ Composite teak deck: aft and toward cockpits, helm platform, transom steps ▪ 1500w vertical windlass 10mm gypsy c/w hand-held remote ▪ Anchor bow roller fitting ▪ Anchor chain stopper ▪ Liferaft locker with convertible fore/aft seat bolster ▪ Sliding companionway door - 2 leaf ▪ Hardtop over cockpit complete with LED lighting ▪ Hardtop bimini over helm c/w s/s supports and LED light ▪ Swimming ladder ▪ Cockpit table ▪ Furler jammer on deck ▪ Bridle mainsheet system (3:1 purchase) ▪ Trampoline ▪ Helmseat ▪ Lifering holder ▪ Acrylic smoke grey tinted windows ▪ Hardtop s/s supports ▪ Side window brows ▪ Hatches: <ul style="list-style-type: none"> - 4 x Size 10 Flush Hatch over heads - 4 x Size 44 Flush Hatch over cabins - 2 x Size 60 Flush Hatch on foredeck (vented) - 1 x Size 70 Flush Hatch over cockpit 	<ul style="list-style-type: none"> ▪ Portlights: <ul style="list-style-type: none"> - 2 x Size 5 in windscreen - 10 x Size 1 in hull side and transom ▪ Guardwires with stanchions, bases, port & stb side gates ▪ Guardwires across bow and stern ▪ 1x Chain locker ▪ 1x Anchor/windlass locker ▪ 2 x Foredeck lockers ▪ Forward lounging cockpit with hardtop c/w watertight saloon access door and sliding hatch for foredeck access ▪ 1 x Forward cockpit locker ▪ 2 x Seats c/w stowage locker under in fwd cockpit ▪ 2 x Pulpits with seat ▪ 2 x Pushpits ▪ 2 x Coachroof s/s handrails ▪ 7 x 330mm mooring cleats ▪ 2 x Winch handles ▪ 1 x Halyard / sheet electric winch ▪ 1 x Halyard / sheet winch ▪ 1 x Main sheet winch ▪ 2 x Genoa cars with pin stop ▪ 2 x Genoa tracks ▪ 1 x Winch handle pocket at helm ▪ 2 x Halyard clutch at helm (Main & Gennaker) ▪ 2 x Genoa clutch at helm ▪ 2 x Mainsheet clutch at helm ▪ 2 x Reef clutch at helm ▪ 1 x Mainsail outhaul clutch at helm ▪ 1 x Clutch and cleat on mast for genoa halyard ▪ 4 x Padeyes to allow for gennaker tackle ▪ Drinks holders: <ul style="list-style-type: none"> - 4 in forward cockpit - 2 at helmstation - 1 in cockpit
PLUMBING INSTALLATION	MAST, RIGGING & SAILS
<ul style="list-style-type: none"> ▪ Leopard 48 2016 - Electric flushing toilets: 2 Jabsco quiet flush (seawater option; aft cabins) & 2 standard manual toilets (fwd cabins) ▪ Leopard 48 2017 - Electric flushing toilets: 4 Jabsco quiet flush (seawater option) ▪ Watermaker (12V), 60L/h with controller ▪ Deck wash fitting - dual fresh/salt water system ▪ Stern shower: hot/cold water ▪ Hot and cold pressurized fresh water system consisting of: <ul style="list-style-type: none"> ▪ 2 x Water tanks, 1000L total capacity ▪ 1 x 3.5 GPM fresh water pressure pump with 1L accumulator tank ▪ 2 x Hot water cylinders 12USgal / 46ltr total capacity ▪ 4 x Shower drain pumps with filters ▪ 2 x Holding tanks - 42USgal / 160ltr total capacity (4 cabin) ▪ 2 x Electric bilge pumps (keel sump) with float switches and alarm at switch panel ▪ 2 x Manual bilge pumps with strum boxes (keel sump) ▪ 2 x High water bilge float switches with alarm at switchpanel ▪ 2 x Elec. bilge pumps (engine room) c/w alarm at switch panel 	<ul style="list-style-type: none"> ▪ Electric Sheet winch - Lewmar 55EST - 1 off ▪ Lazy Bag with Lazy Jack ▪ Natural anodized mast ▪ Natural anodized crossbeam c/w mooring cleats ▪ Wind indicator ▪ Mainsail full battened c/w 2 rows reefs ▪ Additional spare conduit with messenger in mast
RUNNING RIGGING	GENERAL EQUIPMENT
<ul style="list-style-type: none"> ▪ 2 x Main sheets (3:1 purchase) ▪ 2 x Genoa sheets ▪ 3 x Halyards (main, genoa & spare) ▪ 2 x Single line reefs lead aft ▪ Main boom topping lift ▪ Main outhaul led to helm station 	<ul style="list-style-type: none"> ▪ Anchor and chain ▪ Anchor bridle, shackles and hook ▪ Fenders (x6), mooring lines (x4, 16mm x 10m), spring lines (x2, 16mm x 15m) ▪ Ocean liferaft and full safety equipment ▪ Dinghy ▪ Outboard engine 9,9 HP ▪ 6 x Fire extinguishers ▪ Owner's Operating Manual ▪ CE Certification ▪ NMMA Certification

Sailing catamaran Leopard 48

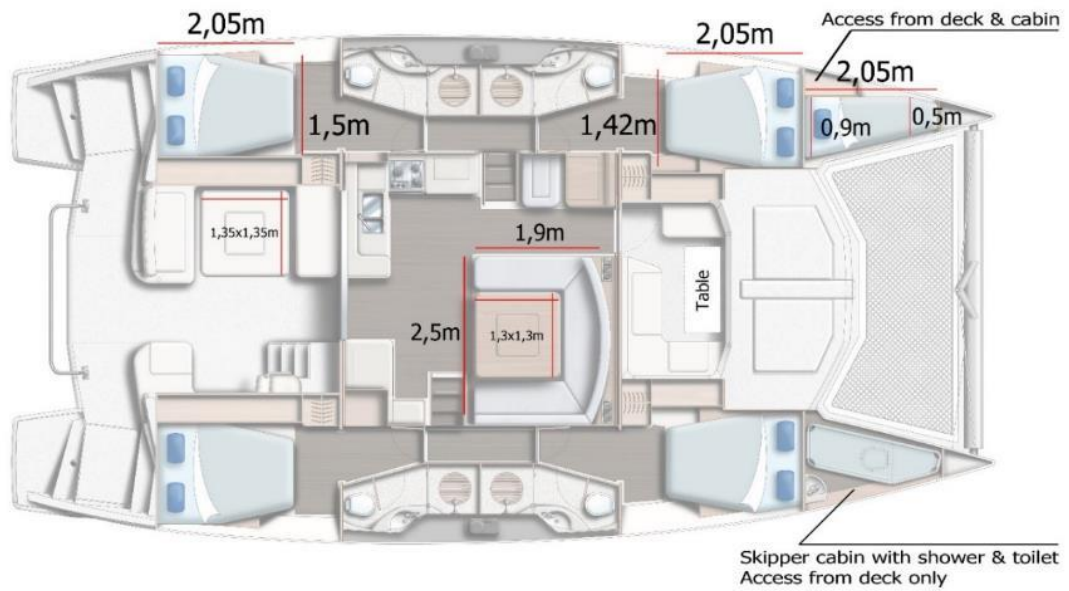

Sailing catamaran Leopard 48



Sailing catamaran Leopard 48

