

Bavaria 41 Cruiser



2015/ Lefkas



www.e-sailing.gr

www.e-sailing.gr

www.e-sailing.gr

cruise 41

www.e-sailing.gr

RIA 46

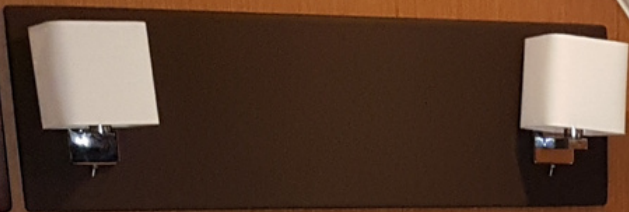



ATTENZIONE
Questo è un prodotto
destinato all'uso
domestico e non
deve essere utilizzato
per scopi professionali.
L'uso improprio può
causare danni e
incidenti.



Standard Equipment:

Roller mainsail

Roller Genoa

Dinghy

Bimini

Sprayhood

Autopilot

GPS 10" in Cockpit



Extra Equipment:

Solar Panel

Bow Truster

Electric Anchor Winch

Hot Water

Deck Shower

Radio/CD Player

TV

Cockpit Speakers

Full set of electronic

instruments

Complete safety

Galley equipment

Specifications:

Built: 2015

Licensed: 7 pax

Length: 12.35m.

Beam: 3.96m

Depth: 2.05m

Water: 210lt

Fuel: 210lt

Cabins: 3

Heads: 2



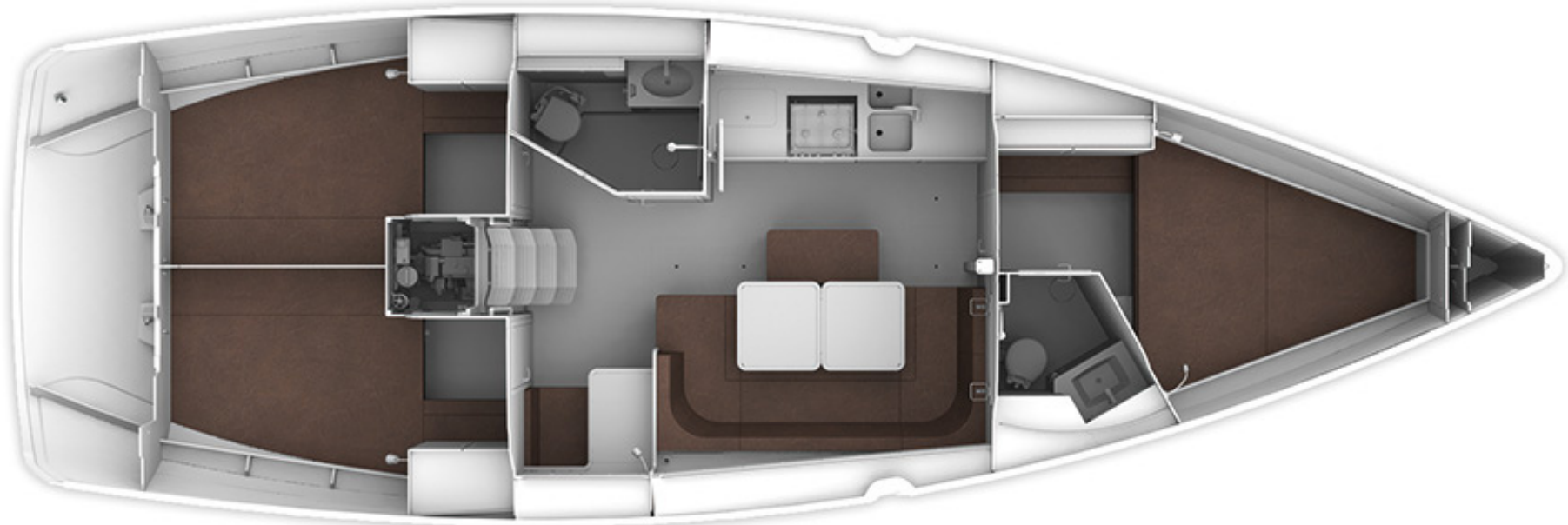

One week sailing from Lefkas:

Lefkas / Preveza - Syvota 35 n.m.

Syvota - Corfu (Kerkyra) 28 n.m.

Corfu (Kerkyra) - Paxoi 32 n.m.

Paxoi - Fiskardo 48 n.m.

Fiskardo - Meganisi 18 n.m.

Meganisi - Lefkada (Lefkas) 12 n.m.

Lefkada (Lefkas) - Preveza 10 n.m.

Two weeks sailing from Lefkas:

Lefkas / Preveza - Syvota 35 n.m.

Syvota - Corfu (Kerkyra) 28 n.m.

Corfu (Kerkyra) - Paxoi 32 n.m.

Paxoi - Fiskardo 48 n.m.

Fiskardo - Ithaki 15 n.m.

Ithaki - Zakynthos (Zante) 38 n.m.

Zakynthos - Ag. Efimia (Kefallonia) 35 n.m.

Ag. Efimia (Kefallonia) - Astakos 30 n.m.

Astakos - Kalamos 12 n.m.

Kalamos - Meganisi 10 n.m.

Meganisi - Lefkada (Lefkas) 12 n.m.

Lefkada (Lefkas) - Preveza 10 n.m.