

Bali 4.2 • Ferdi

Marina di Stabia

Year	2022
Cabins	4+1
Berths	8+2+1
Toilets	4+1
Category	A 12
Overall length	12.84 m
Overall beam	7.7 m
Keel draft	1.12 m
Total sail	90 mq
Engine	2 x Yanmar 45 HP
Fuel capacity	640 lt
Water capacity	800 lt

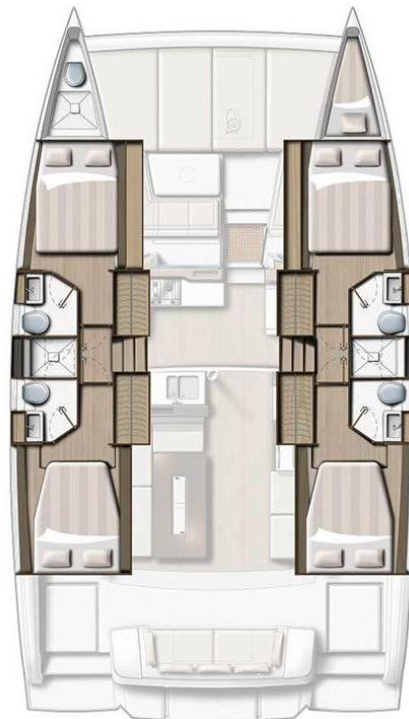

The Boat

The BALI 4.2 Open Space represents the evolution of the species, refining the design features of the previous models and offering new cutting-edge design solutions. The large lounge has a tilting back door, making it a multifunctional space. The external cockpit has been moved forward, offering improved comfort both during navigation and at anchor. The real novelty is the door that joins the two spaces. Large sunbathing areas are located at the bow and on the flybridge, offering plenty of choice in terms of panoramas to enjoy your cruise. The sailing qualities of the Bali 4.2 have also been improved, with the sail plan including 90 square metres of sail surface.

Equipment & Comfort

Battened mainsail 100%	Furling self tacking jib
Electrical winch for mainsail halyard	Automatic first and second reef
Pulpits with polywood seating	Autopilot
Wind instruments	VHF
Plotter GPS	Inverter
Electric toilets	220V Generator
Air conditioning	ZP Watermaker 200lt/hour
Hydraulic system for salon tilting bay door	External shower with Warm water
220V and 12V sockets	Fridge freezer 336 L with chilled water
Rear cockpit and forward cockpit cushions	Chaise longue cushions on helm station side
Radio&Music player	Grill on cockpit
Tender VTR keel	Nespresso coffee machine
Outboard engine 9.9 HP (opt)	Code 0 with furler (opt)



